

BUILD A DIE COMPONENTS

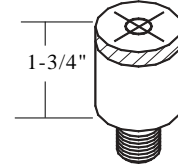

ELECTRODES	
PART #	DIA.
TDTE-2-19-BLANK	3/4"
TDTE-2-22-BLANK	7/8"
TDTE-2-25-BLANK	1"
TDTE-2-32-BLANK	1-1/4"

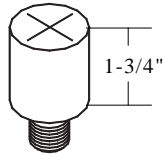

FIXED PIN NUT ELECTRODES		
PART #	NUT SIZE	DIA.
TDTN-2-25-611	#8	1"
TDTN-2-25-612	#10	1"
TDTN-2-25-613	#12	1"
TDTN-2-25-614	1/4"	1"
TDTN-2-25-615	5/16"	1"
TDTN-2-25-616	3/8"	1"
TDTN-2-25-617	7/16"	1"
TDTN-2-25-618	1/2"	1"
TDTN-2-25-614MM	4MM	1"
TDTN-2-25-616MM	6MM	1"
TDTN-2-25-618MM	8MM	1"
TDTN-2-25-6110MM	10MM	1"
TDTN-2-25-6112MM	12MM	1"

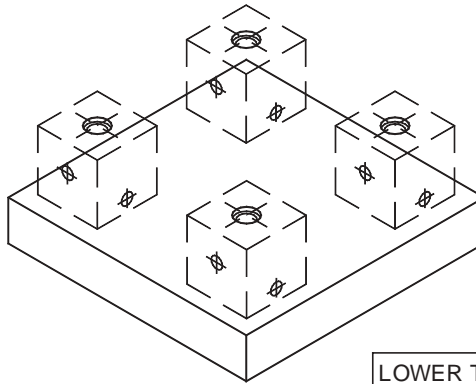
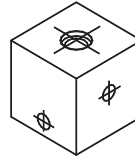
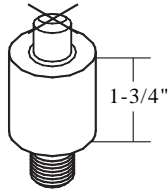

STUD ELECTRODES		
PART #	NUT SIZE	DIA.
TDTS-2-25-601	#8	1"
TDTS-2-25-602	#10	1"
TDTS-2-25-603	#12	1"
TDTS-2-25-604	1/4"	1"
TDTS-2-25-605	5/16"	1"
TDTS-2-25-606	3/8"	1"
TDTS-2-25-607	7/16"	1"
TDTS-2-25-608	1/2"	1"
TDTS-2-25-604MM	4MM	1"
TDTS-2-25-606MM	6MM	1"
TDTS-2-25-608MM	8MM	1"
TDTS-2-25-6110MM	10MM	1"
TDTS-2-25-6112MM	12MM	1"

NOTE: For copper tungsten faced electrodes please add a "-CT" to the end of the part number.

NOTE: For copper tungsten faced electrodes please add a "-CT" to the end of the part number.

WATER COOLED BLOCKS		
PART #	STOCK SIZE	THD.
T-4000-01	2" X 2"	5/8-11

LOWER THREADED BODY			
PART #	THD. SIZE	DIA.	USE HEAD
TDT-25-C	5/8-11	1"	TCN-M04 - M09
TDT-30-C	5/8-11	1-1/4"	TCN-M10 - M13
TDT-25-C-CL	5/8-11	1"	TCL-200 SERIES
TDT-30-C-CL	5/8-11	1-1/4"	TCL-300 SERIES

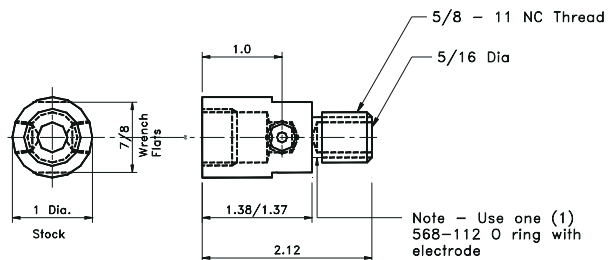
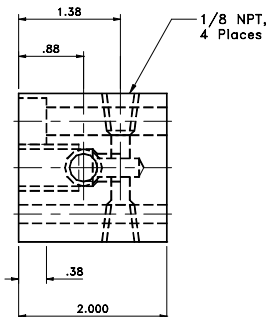
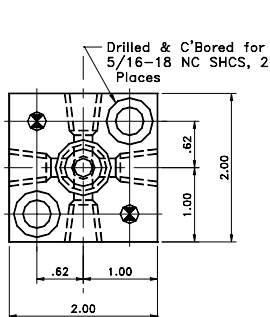

Note - Use with TDT-25/30-C for welding fixtures and dies.