

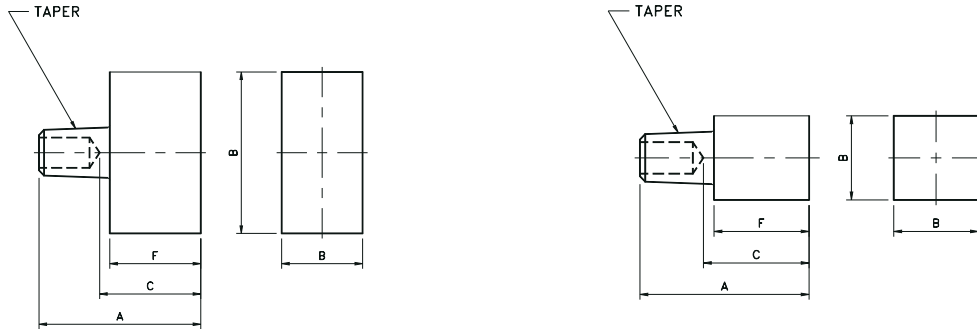

UNITED STATES (313) 875-5145
 FAX (313) 875-6027
 WORLD WIDE WEB: WWW.TIPALOY.COM

CANADA (888) 847-2569
 FAX (888) 551-2055
 E-MAIL TIPALOY@TIPALOY.COM

RECTANGULAR & SQUARE FACE TIPS



EXAMPLE OF PART CODING		
TS	=	TIPALOY SQUARE/ RECTANGULAR FACE
2	=	RWMA CLASS 2 COPPER
5	=	#5 RW TAPER
24	=	LENGTH IN 1/16" (24 = 1-1/2")
10x16	=	WIDTH X LENGTH OF FACE IN 1/16" (10X16 = 5/8" X 1")
18	=	WATER HOLE DEPTH (IF DIFFERENT THAN STD. 7/8")
CT	=	COPPER TUNGSTEN FACING

RECTANGULAR FACE TIPS

Taper	#130 Code No.	Previous Code No.	Overall Length	Weld Face Dimension	Face to Water Hole	Length of Face
	Class 2		A	B	C	F

4 RW Taper (#1 MT)	TS-24-25-10X32	SP-220-1	1-9/16	5/8 x 2	13/16	11/16
	TS-24-26-8X16	SP-248-1	1-5/8	1/2 x 1	1/2	1
	TS-24-24-8X8	SP-261	1-1/2	1/2 x 1/2		7/8
	TS-24-24-8X16	SP-271-1	1-1/2	1/2 x 1		
	TS-24-35-4X16	SPB-329-1	2-3/16	1/4 x 1	1-5/16	

5 RW Taper (#2 MT)	TS-25-25-10X32	SP-220-2	1-9/16	5/8 x 2	13/16	11/16
	TS-25-29-10X16	SP-248-2	1-13/16	5/8 x 1	11/16	15/16
	TS-25-24-10X16	SP-271-2	1-1/2		1/2	5/8
	TS-25-28-10X10	SP-291	1-3/4	5/8 x 5/8	3/4	7/8
	TS-25-35-4X16	SPB-329-2	2-3/16	1/4 x 1	1-5/16	1

* Additional rectangular or square face sizes and lengths available.